

SHAW PARK MASTER PLAN CONFIRMATION

Appendix H

INTRODUCTION AND BACKGROUND

In June of 2010, the City of Clayton retained SWT Design to complete an update of the 2007 Parks & Recreation Master Plan as it pertains to Shaw Park.

Since the completion of the original Parks & Recreation Master Plan, several components of the Shaw Park plan had been further developed. Evolving components included the Inclusion Playground and the Recreational Trails system. In addition, the Ice Rink Task Force, formed to address the changing usage of the Shaw Park Rink, completed their findings, which were underway at the time of the original Parks & Recreation Master Plan.

Two plans for regional change also affected the original Parks & Recreation

- ① Shaw Park Pool Improvements
 - A. Provide Additional Shade
 - ② Ice Rink Options
 - ③ Tennis Center and Court Improvements
 - ④ Permanent Corporate Pavilion
 - A. Comfort Station
 - B. Reconfiguration of Service Area
 - ⑤ Possible Structured Parking Location
 - ⑥ Existing Comfort Station/Pavilion to Remain
 - ⑦ Existing Comfort Station/Pavilion to Remain
 - ⑧ Amphitheatre
 - ⑨ Inclusion Playground
 - ⑩ Relocated Volleyball Courts
 - ⑪ Improve Park Service Roads
 - ⑫ Interior Turn Around/Drop-Off
 - ⑬ Connection to Centennial Greenway
 - ⑭ Lighting for Fields #1 and #2
 - ⑮ New Walking Trail with Signage System
 - ⑯ Park Entry Feature
- Other Items:
- A. New Pedestrian Park Lighting System
 - B. Understory Vegetation Enhancement Plan
 - C. Screen Utility/Service Areas
 - D. Shaw Park Drive Landscape Enhancements



Master plan. The Great Rivers Greenway's Centennial Greenway Plan and the City of Clayton's Central Business District Plan both impact Shaw Park on its periphery.

The Task Force findings, Recreational Trails plans, Inclusion Playground design, and the regional plans for change needed to be incorporated into the Shaw Park plan in order to keep the plan up to date and relevant. The confirmation process allowed the city to bring together the best parts of the new designs and studies and create a current and germane master plan for Shaw Park.

PROJECT GOALS

Three major goals were defined by the city at the beginning of the master plan confirmation process. They included the following:

- *Update Shaw Park Plan*

The final master plan should be developed in keeping with the original master plan while bringing together the best parts and components of all of the proposed individual plans to create a comprehensive design for Shaw Park.

- *Utilize Public Engagement*

The master planning process should engage the public and solicit public consensus and feedback for a final plan that best represents the desires of the community.

- *Follow Parks and Recreation Department Mission Statement*

The Parks and Recreation Department has a strong vision for the City of Clayton. Its mission statement should guide plan development: “To Improve the quality of life for our citizens through the provisions of comprehensive leisure services and recreational opportunities to individuals of all ages, abilities, and interest in a safe, healthy and pleasant environment.”



Typical Rolling Topography of Shaw Park

PROCESS

The methodology used in preparing the updated master plan included meeting with staff and the general public, while also reviewing the 2007 Master Plan and the supplemental plans completed for the park. City staff and public input were pivotal to the planning process and the creation of the final revised master plan.

The process to complete the master plan included three tasks: Task I Data Collection, Task II Analysis, and Task III Concept Design Consensus. The following pages describe the tasks and provide detail regarding each phase of work.

TASK I DATA COLLECTION

Data collection, the first step in the process, involved the development of the “foundation” for the updated master plan. In this phase of work the following items were completed: 1) SWT reviewed the 2007 Parks & Recreation Master Plan and the status of each of the five plans that modified or affected Shaw Park; 2) SWT met with members of the staff, administration, park commission and stakeholder groups to obtain input regarding park programming, user needs, and potential park development; and 3) SWT met with the public to garner input regarding the needs and desires of the community for the park.

There were five meetings held to discuss and collect “foundation” data regarding the status of the supplemental plans, the current desires for Shaw Park and the needs of the community. Minutes from each of the meetings follow.



2007 Shaw Park Master Plan

Staff Data Collection Meeting - May 19, 2010

Meeting Attendees: Patty DeForrest (Director of Parks and Recreation), Eric Gruenenfelder (Superintendent of Recreation), Toni Siering (Superintendent of Parks and Recreation Operations), and Susan Renard (Superintendent of Parks).

2007 Master Plan

Status:

- They are moving on the playground.
- May be under construction by first public meeting.

- Additional shade structure at pool has been installed.
- Lighting at fields #1 and #2 has been installed.
- Understory landscape enhancements are ongoing.
- Screening and landscape at Shaw Park Drive have been done.

Opportunities:

- Additional Park Drop off is a positive idea.
- The incorporation of a permanent corporate pavilion is a positive idea.
- The location of the amphitheater is good.
- Formal entry nodes are a positive idea.

Constraints:

- There is a lack of parking.



Inclusive Playground Plan

Playground Plan

Status:

- In construction documentation process.

Needs MSD approval.

- Construction should be taking place in mid June.
- One month construction time line.

Opportunities:

- To tie into the remainder of the park.
- Create a sensory garden where the existing playground sits.



Recreational Trail Plan

Recreational Trail and Centennial Greenway

Status:

- Holding on Implementation of Recreational Trails Plan.
- Centennial Greenway is currently under design by GRG.

Opportunities:

- The amphitheater location is good in the Rec. Trails Plan.
- The sculpture walk is positive in the Rec. Trails Plan.
- There are educational opportunities in the Rec. Trails Plan.
- Connectivity for both plans is a positive opportunity.
- Clayton does not have to build the GRG trail.

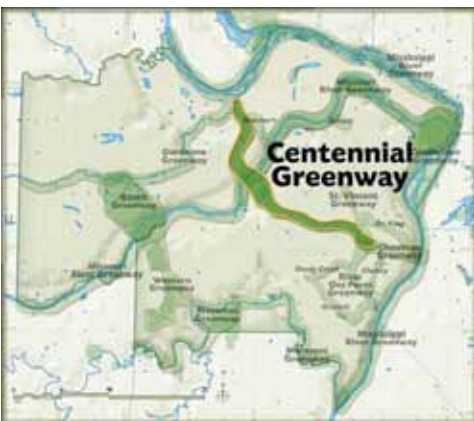

Centennial Greenway Plan

Ice Rink Task Force Plan

Status:

- Holding on implementation.

Opportunities:

- The function of the ice rink is just as important as the revenue it brings to the city.
- With a cover usage could be increased; a multi-use space could be created for concerts, farmers markets, ice, restaurant, small field space.
- Change of entrance area to a drop off point closer to the ice rink is positive.

Constraints:

- There is a lack of parking.
- Funding.
- 67% of public want the open ice and only 5% of public use the ice.
- The rink is losing money.



Ice Rink Task Force Plan

Central Business District Plan Master Plan

Status:

- Being Completed Now.

Opportunities:

- Activity and connectivity in the park and city.
- Development of performance venues.
- Plan may help push corporate involvement in the park.
- Plan promotes the removal of the “mulch pile”.

Constraints:

- A formalized entry may mean the relocation of the tennis courts.
- Lack of Parking.
- Will bring more activity, heavy use, to the park.
- Suggested removal of ball fields which have just been renovated.

The Downtown Districts

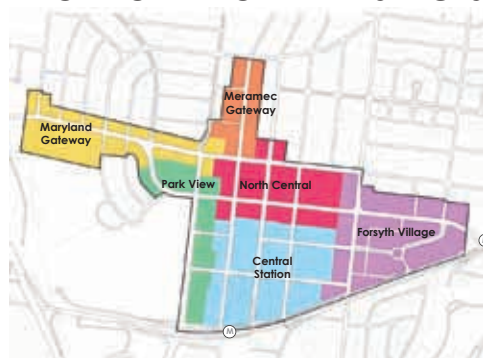

Central Business District Plan Master Plan

City Administration Data Collection Meeting - June 7, 2010

Meeting Attendees: Gary Carter (Economic Development), Jason Jaggi (Interim Planning and Development Director), Lenore Toser-Aldaz (Deputy

City Manager) and Patty DeForrest (Director of Parks and Recreation).

- Softening of Brentwood edge while maintaining existing features.
- Corporate pavilion located closer to Brentwood for access and parking availability.
- Make fields 1 and 2 a multi-use space for concert/events.
- Strengthen connection to downtown / more pedestrian friendly.
- Could locate a pad somewhere near fields for setting up band trailer for events.
- Preference for concept “3”, from the Ice Rink Task Force Plan, with the pavilion as a restaurant opportunity.
- CBD parking garage just across Brentwood.
- Heavily underused parking garage North East of the park could be opened for public.
- Originally an amphitheater was proposed for the NE corner of the park during initial construction.
- Item #5 (parking structure) from '07 Master Plan likely not feasible at this time due to expense.
- Locate cost estimates for ice rink design options for next presentation.
- Get public’s view on amphitheater usage v.s. location within the park.
- Find out from the public if they want a more “active” park.
- Develop prioritized list of projects within the park.
- The idea of “frozen” paths (leisure ice) through the park was discussed as a wonderful idea but probably not feasible.



Aquatic Center Entrance

Parks Commission Data Collection Meeting - June 7, 2010

Meeting Attendees: Parks Commission Board and Parks and Recreation Staff.

- CBD bullet point should be removed from prior studies slide as it is ongoing. Mention it in the presentation but only briefly, the inter-connectivity aspects of it but don’t go into details anywhere.



Existing Sidewalk

- Amphitheater discussion, should it be more geared toward a “Shakespeare in the park” type event or a more formal type of programming and space.
- Show current usage statistics for the park if available or mention that this needs to be studied for future development. Compare these to other parks of similar sq. ft.
- Stake holder questions, will you use it? Will it generate revenue for maintenance etc?
- Add the Clayton Parks and Recreation mission statement to the presentation.
- Walking trails are historically the highest priority to the public based on prior studies.
- Look at the distribution of passive and active spaces and how they effect one another.
- Add a task 4 to the schedule (Review by Park and Rec. Commission)

Ice Rink

- Give credit that a lot of staff and consultant hours went into the current schemes.
- Note that all three schemes have a cover over the rink.
- The building is not air-conditioned.
- Discussion points for future meetings: covered or not, turf on rink in summer or not, restaurant or not, etc.

Stake Holders Data Collection Meeting - June 9, 2010

Meeting Attendees: Stakeholder group organized by Parks and Recreation Staff.

2007 Study Review

- The revenue stream from the permanent pavilion is important.
- An improved central entry and sculpture area, creating a sense of arrival, and a “signature” entry, are important.
- Pedestrian crossings could be made more pedestrian friendly to get more people walking into the park.
- “Building Out” the park and too much development are a concern.

Multi-use facilities should be sought, so additional buildings do not need to be built.

- This plan does not emphasize a main entry into the park.
- Parking is a problem with this plan. There is not enough parking currently. Additional programming in the park will increase the need for parking.
- Additional rest rooms may be necessary if additional uses are planned.

Ice Rink Task Force Plan

- A cover would extend ice usage. Currently the ice is used for 70 to 90 days a year. With a cover, the ice could be used from mid November to mid March, approximately 120 days.
- With a cover, other non-ice related activities could take place in the “off season”; farmers markets, parties, movies in the park, plays, concerts, etc. Artificial turf could be added for use with other sports; lacrosse, tee-ball, etc... This could make the structure a four season/year round facility.
- The main entry of the park is important and needs to be emphasized.
- This plan depicts a multi-use facility and the improved entrance, meeting two important needs in the park.
- The addition of the restaurant is important to help enliven the park and provide an important amenity for park users.
- Views into the park should be maintained.
- A balance of activity and green space needs to be maintained.

General Suggestions for Public Meeting

- All future plans for the park should look at the “big picture”.
- Utilize more images to help depict the plan for the ice rink.
- Utilize a workshop or open house format for the public meeting to get more feedback from meeting attendees.



Existing Park Entry

Public Forum Data Collection Meeting - June 17, 2010

Meeting open to the public.



Existing Corporate Tent

- The proposed nature area is a good idea and should include a pond or water feature.
- Another nature area could be added at the 2007 Master Plan location for the amphitheater.
- The 2007 Master Plan amphitheater location could be utilized temporarily until the ice rink is redesigned to handle events like concerts and plays.
- A concession/restaurant should be opened to the public in the park. It should be centrally located in the park. Between the pool and the ice rink is a good central location. This location could take advantage of the views to the pool, the ice rink and into the park.
- Nature areas should be added along the western perimeter of the park.
- The corporate tent/pavilion should have a full kitchen.
- The amphitheater shown in the 2007 Master Plan should be replaced with a lake.
- The Ice Rink should be turned into an “all season” facility. It should be covered, but open on the sides. It should accommodate temporary turf in the summer season, for sporting events.
- All trees should be surveyed prior to park improvements.
- There should be a food and beverage kiosk in the “bowl”/low area on the north side of the park.
- There should be a water feature in the “bowl”/low area on the north side of the park.
- The playground should incorporate a water feature.
- The existing ice rink support building should be used as a restaurant and for party rooms.
- Do not build structures that would block views into the park.
- Extend the ice rink an additional 15’.
- A centralized stream/brook should be added down the center of the park.
- A drinking fountain and kiosk should be added at the Centennial Trail trailhead.

- A pond should be added just north of the southern-most playground. Small pavilion/benches should be added around the pond.
- A garden could be added around the 2007 Master Plan amphitheater location.
- A major/formal park entry should be made and emphasized at the north side of the ice rink.
- The service area near the corporate tent should be removed.
- A centralized “feature” should be added along the east-west trail in the park.
- Pedestrian crossings on Brentwood Blvd. should all be improved.
- A waterfall should be added in the “bowl” at the north end of the park.
- Parking and way-finding should be improved for future development of the park.

TASK II ANALYSIS

The second step in the planning process was the analysis of the information compiled during data collection. In this phase of work the following items were completed: 1) SWT evaluated the opportunities and constraints of the 2007 Parks & Recreation Master Plan and of each supplemental plan; and 2) SWT evaluated public, staff, administration, park commission and stakeholder input to identify priorities and opportunities.



Park Open Space

TASK III CONCEPT DESIGN CONSENSUS

The last step in the planning process was the development of a consensus for the final master plan. The consensus was confirmed and the information was combined and formalized in the final report document. In this phase of work the following items were completed: 1) SWT presented a consensus program based on the analysis of data collection to staff for approval; 2) SWT developed an updated concept plan based on the finalized consensus; 3) SWT reviewed the concept plan with staff; and 4) SWT created a final updated master plan document based on the concept plan.

Minutes from the consensus meeting with Staff to determine the final master plan program and concept follow.



Bicentennial Garden

Staff Consensus Meeting - June 23, 2010

Meeting Attendees: Patty DeForrest (Director of Parks and Recreation), Eric Gruenfelder (Superintendent of Recreation), Toni Siering (Superintendent of Parks and Recreation Operations), and Susan Renard (Superintendent of Parks).

2007 Parks and Recreation Master Plan:

- Proceed with Permanent Pavilion for Corporate Activities. To be identified as “Shaw Park Pavilion” and reference it as a gathering space for large events, family reunions and corporate parties.
- Service Area at “Shaw Park Pavilion” is not feasible.
- Possible Parking Structure at High School is not feasible.
- Proceed with Inclusion Playground and Other Associated Amenities.
- Proceed with improved Park Entries and Entry Features.
- Eliminate Amphitheater (Ice Rink Modifications will eliminate the need for this amenity.)
- Proceed with relocated Volleyball Courts.
- Proceed with Centennial Trail Trailhead Location.

Shaw Park Recreational Trails Plan:

- Incorporate Trails per Plan (Incorporate all trails at pedestrian scale, 8’ wide.)
- Include Sculpture Walk.
- Include Nature Garden.
- Modify “Shaw Park Pavilion” Service Area per Plan.
- Proceed with Centennial Trail Trailhead Location.

Centennial Trail Plan:

- Proceed as Proposed by GRG. (Continue to coordinate with them. Trailhead shall be located per 2007 Master Plan and the Recreational Trails Plan.)

Ice Rink Task Force Plan:

- Incorporate the Ice Rink as a “365 Day per Year”/ Multi-Use Facility
- Incorporate a Stand Alone Restaurant between the Ice Rink and the Swimming Pool
- Emphasize the Entry into the Park at Bicentennial Park
- Enhance Connection to the Ice Rink (Multi-Use Facility) from Drop Off on Brentwood

Inclusive Playground:

- Incorporate Playground into Master Plan per Current Drawings, Including Water Play Area
- Incorporate Sensory Garden

Central Business District Plan:

- The park could benefit from a restaurant/food and beverage venue.



- Visual connections in and out of the park should be strived for.
- The park edges could be softened.

FINAL MASTER PLAN

This final master plan was presented to the Park and Recreation staff and to the Board of Aldermen. The plan is designed to bring together the best parts and components of all of the previous individual plans and the 2007 Parks & Recreation Master Plan. The final master plan is a comprehensive design that is based on input garnered during the public engagement process and meet the needs and desires of park users.



Plan Key

- | | | | |
|---|--|--|----------------------------------|
| ① Aquatic Center | ⑥ Recreational Trail | ⑪ Sand Volleyball Court | ⑮ Sculpture Node |
| ② Bicentennial Garden with Sculpture Node | ⑦ Shaw Park Pavilion | ⑫ Inclusion Playground | ⑰ Sculpture Walk |
| ③ Multi-Use Facility | ⑧ Shelter | ⑬ Clayton High School | ⑱ Water Feature / Sculpture Node |
| ④ Tennis Center | ⑨ Nature Garden | ⑭ Parking | ⑲ Sensory Garden |
| ⑤ Baseball / Softball Fields | ⑩ Centennial Greenway Trail Connection | ⑯ Restaurant with Outdoor Dining and Sculpture Plaza | ⑳ Entry Node with Special Paving |
| | | | ㉑ The Center of Clayton |



Aquatic Center

① Aquatic Center

Additional shade structures should be added where appropriate, as described in the 2007 Master Plan.



Bicentennial Garden

② Bicentennial Garden with Sculpture Node

The Bicentennial Garden will serve as the main entry to Shaw Park. The sculpture area is maintained and emphasized. This sculpture node will be the first in a series that stretches in a westerly direction across the park.

③ Multi-Use Facility

This facility will be a modification of the existing ice rink facility. It will have a shade covering and provide a 365 day a year venue for events such as concerts, farmers markets, plays, indoor and outdoor sporting events, as well as ice skating. Access to the facility will be reconfigured to provide a single access control point for more efficient facility management. (See page 18 for more detail.)



Tennis Center and Softball / Baseball Fields

④ Tennis Center

There are no major changes to the Tennis Center. A connector walk will be added just north of the tennis center. The walk will extend from Brentwood Boulevard to the tennis center building.

⑤ Baseball / Softball Fields

There are no changes to the baseball / softball fields. They shall remain per the 2007 Master Plan.

⑥ Recreational Trail

The recreational trails have been modified to eliminate some redundancies, create more direct linkages, and reduce the amount of pavement within the park. Pedestrian scale enhancements should be added to the trails while auto oriented attributes should be removed. (See page 20 for more detail.)

⑦ Shaw Park Pavilion

The pavilion will provide a permanent structure for corporate events. It will be approximately the same size as the existing tent but will house a comfort station and caterer's kitchen. A paved plaza will be added on the south side of the pavilion that connects to the trail system, for vehicle access. The service area will be relocated to eliminate interruption of views into the park. (See page 21 for more detail.)



North Pavilion

⑧ Shelter

There are no changes to the north and south shelters. They shall remain per the 2007 Master Plan.

⑨ Nature Garden

Two nature gardens are planned to add diversity to the typical Shaw Park landscape. These gardens will provide habitat for wildlife. They will serve as outdoor classrooms and educational opportunities for nature lovers, school children and general park users. The gardens will be sustainable environments that will require limited mowing and watering. They will help reduce and filter water run off. (See page 22 for more detail.)



Future Trail Location

⑩ Centennial Greenway Trail Connection

There is no change to the location of the Centennial Greenway Trail connection. It shall remain per the 2007 Master Plan.

⑪ Sand Volleyball Court

Per the 2007 master Plan recommendations the sand volleyball courts shall be reoriented to minimize sun angle affects on play.



Sand Volleyball Court

⑫ Inclusion Playground

There are no changes to the inclusion playground. It shall remain per the 2007 Master Plan. (The playground was finished at the time of the completion of this report.)



⑬ Clayton High School

The high school is unaffected by the master plan.

⑭ Parking

The parking lot is unaffected by the master plan.



⑮ Restaurant with Outdoor Dining & Sculpture Plaza

A restaurant venue is planned to provide a dining alternative in the park. The venue will serve multi-use facility users, aquatic center users, and general park users. The building's architecture would fit into the park, being light, airy and open so as not to block views into the park. A sculpture plaza will incorporate outdoor dining on the lower level and an upper terrace will provide outdoor dining opportunities. (See page 19 for more detail.)

⑯ Sculpture Node

Sculptures shall be sited at focal points along the east-west pedestrian path through the park. These nodes will be created at the intersections of paths. Sculptures will be surrounded by ornamental plants and provide a visual break and point of interest within the park. (See page 21 for more detail.)

⑰ Sculpture Walk

A pedestrian walk meanders through the park. It is anchored by the restaurant sculpture plaza on the east side of the park. On the west end, the walk is anchored by a formal park entry node. Multiple sculptural nodes are sited along the path. The walk provides an ideal setting for art and education. (See page 21 for more detail.)

⑱ Water Feature / Sculpture Node

An interactive water feature incorporating sculpture will be sited near the playground and sensory garden. This sculpture will provide a diversity for the senses of sight, sound and touch. (See page 21 for more detail.)



⑲ Sensory Garden

The sensory garden is to be constructed in the location of the old playground. The garden will be an extension of the playground and add to the educational opportunities for children and park users. (See page 21 for more detail.)

⑳ Entry Node with Special Paving

There are no changes to the amenities to be included at the park entry features. They shall remain per the 2007 Master Plan. The locations of the entries has changed slightly. (See page 21 for more detail.)

㉑ The Center of Clayton

There are no changes to the Center of Clayton. Recommendations remain per the 2007 Master Plan.

Multi-Use Facility

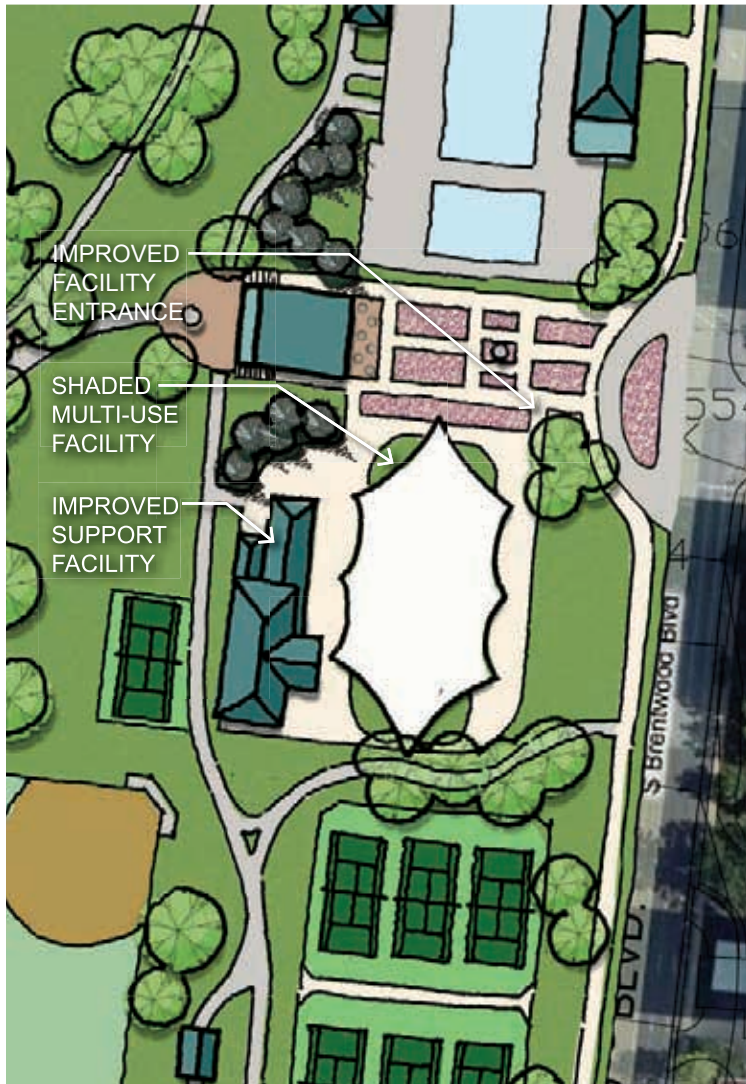

Plan View



Farmer's Market



Possible Shade Structure



Concert Venue



Ice Rink Activities



Theatrical Productions



Indoor Sporting Opportunities

Park Entry and Restaurant

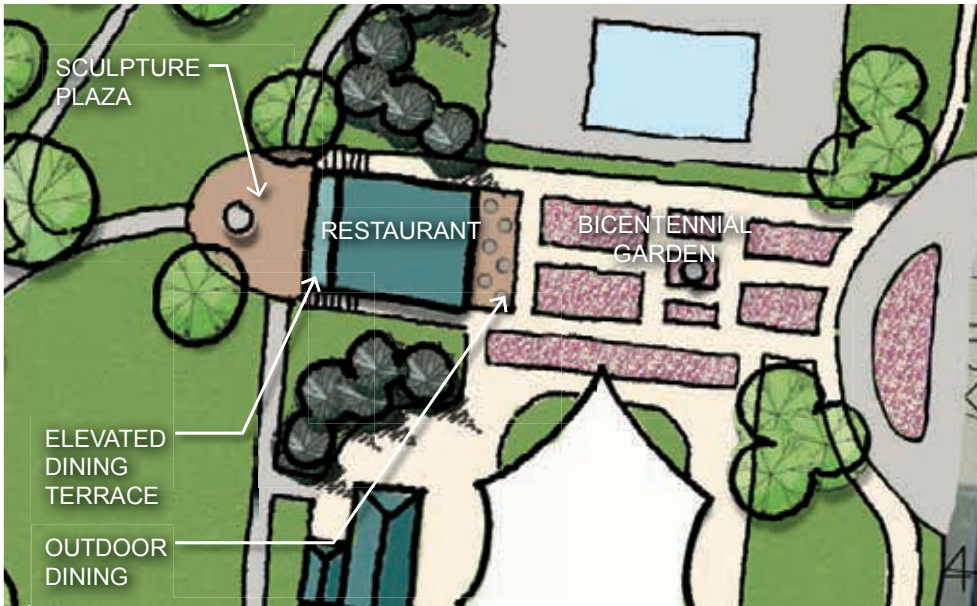

Plan View

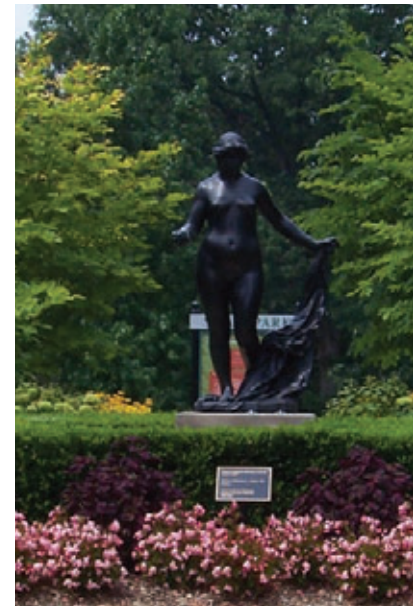

Bicentennial Garden Sculpture



Architectural Concept



Outdoor Dining Plaza



Architectural Concept







Dining Terrace

Improved Recreation Trails



Plan View

Focus Areas:

-  Pedestrian Trails
-  Entry Nodes
-  Sculpture Nodes
-  Nature Garden

Recreational Trail Design

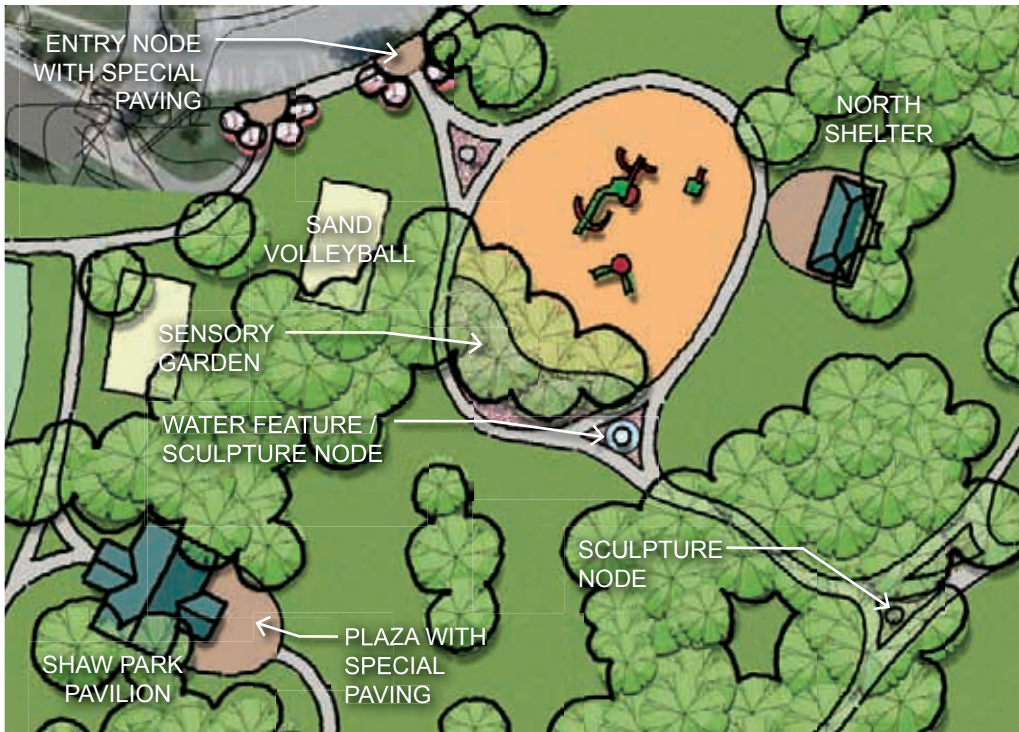

Plan View

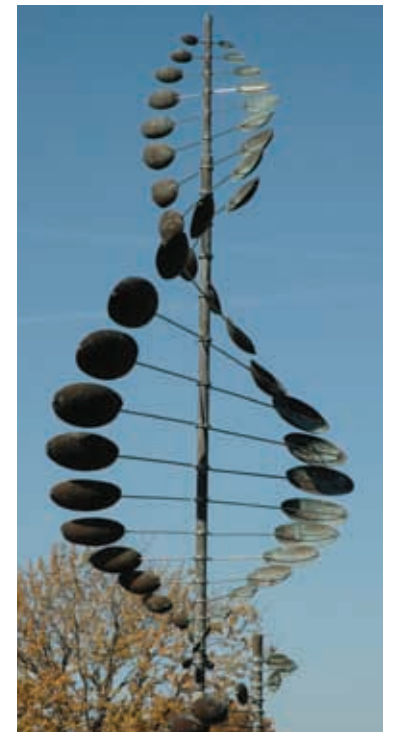

Sculpture



Section Through Sculpture Node



Existing Shelter Architecture



Pedestrian Scale Lighting



Pedestrian Path



Playground Site Plan



Special Paving and Planting for Entry Node

Nature Garden



Plan View



Soft Path



Interpretive Signage



Garden Sculpture



Nature Garden Classroom



Nature Garden Rendering